

Washer extractor

ELD-665 Compass Pro



Washer featuring exceptional savings and effortless use



Priority on people

Certified ergonomic design with a human-centered approach for an outstanding user experience

Compass Pro® microprocessor offers:

- Easy program selection
- Language selection
- Quick selection and option buttons for the most frequently used wash programs and options
- Wash program packages optimized on Economy, Performance and Time



Long-term savings

Extremely low water and energy consumption – see table below

- High extraction force for efficient dewatering
- Super Balance guarantees the correct extraction force



Pure control

Monitoring of the status of the equipment and performance from anywhere, allowing to take action to improve the business

- Washers connectable to OnE Laundry, the personal assistant for hygiene validation, process management and revenue management



Global Advanced Hygiene

Global Advanced Hygiene program package* with proven log 6 reduction** disinfection of textiles through the laundry process, fulfilling the criteria of all local approved standards

Main options

- Automatic liquid detergent supply (optional I/O board)
- Connection to booking- /payment- system or coin meter



* Programs available in the standard library of all products, excluding products for specific segments where water temperature is not controllable.

** Log 6 reduction equals to 99,9999% viral infectivity reduction. The efficacy of reduction of SARS-CoV-2 and other pathogens in the process is confirmed by RISE (The Research Institute of Sweden) on the basis of Electrolux Professional laboratory data.

Main specifications				ELD-665			
Rated capacity, filling factor 1:9		kg/lb		28/62			
Drum, volume		litre/ft ³		250/8.8			
	diameter	ø mm/inch		725 / 28 9/16			
Extraction		rpm		566			
G-factor				130			
Standard heating alternatives	electricity	kW		18.0			
	steam			x			
	non-heated			x			
Modified energy factor				1.5			
Integrated water factor				12.8			
Consumption data "Warm"				EI		Steam***	
Total time		min		Full load, 28 kg / 62 lb	Half load, 14 kg / 31 lb	Full load, 28 kg / 62 lb	Half load, 14 kg / 31 lb
Water consumption (cold+hot)		litre/gallon		31	30.5	31	30.5
Energy consumption (motor/heating/hot water)		kWh		377/100 + 32/9	337/89 + 27/7	409/109 + 0/0	364/96 + 0/0
Steam consumption		kg/lb		0.25/1.9/2.1	0.2/1.1/2.2	0.3/-	0.3/-
Residual moisture		%		-	-	6/13.2	5.0/11.0
				65	74	65	74

* Water temperature 59°F cold water and 149°F hot water.

** Programs with AS.

*** Depending on steam pressure.

Electrical connections					
Heating alternative	Main voltage	Hz	Heating power kW	Total power kW	Recommended ITCB A
Steam or Non heated	120-480V 1 - 208-480 V 1 -	60 60	- -	0.8 1.5	15 15

* Total power and recommended fuse does not depend on the heating power in those cases.

Water and steam connection		ELD-665	
Water valves	DN/inch	20 / 3/4	
Water pressure	psi	30-90	
Capacity at 300 kPa / 44 psi	l/min / gallon/min	60 / 16	
Drain valve	ø mm/inch	75 / 3	
Draining capacity	l/min / gallon/min	170 / 45	
Steam valve	DN/inch	15 / 1/2	
Steam pressure	psi	40-90	
Liquid detergent supplies		5	
Floor requirements			
Frequency of the dynamic force	Hz	8.3	
Floor load at max extraction	kN / lbs force	3.8 ± 4.9 / 854 ± 1102	
Sound levels			
Sound power/pressure level at extraction*	dB(A)	70/54	
Sound power/pressure level at wash*	dB(A)	66/50	
Heat emission			
% of installed power, max		5	
Shipping data**			
Weight	net, kg/lbs	256 / 564	
Shipping volume	m ³ /ft ³	1.66 / 59	
Accessories			
Steel base		x	
Hose kits for water or steam		x	
Fluff collector		x	
Dimensions in mm / inch			
A Width	830	32 11/16	
B Depth	1030	40 9/16	
C Height	1430	56 5/16	
D1	470	18 1/2	
D2	550	21 5/8	
E	1590	62 5/8	
F	1135	44 11/16	
G	80	3 1/8	
H	1330	52 3/8	
I	325	12 13/16	
J	245	9 5/8	
K	1290	50 13/16	
L	1205	47 7/16	
M	280	11	
N	105	4 1/8	
O	265	10 7/16	
P	160	6 5/16	
1 Display	7 Drain valve		
2 Door opening ø 435 mm / 17 1/8 inch	8 Liquid detergent supply		
3 Detergent box	9 Electrical connection		
4 Cold water	10 Steam connection		
5 Hot water			
6 Re-used water			

Front and side panels in silver grey and dark blue (color samples can be ordered on part number 472998313).

* Sound power levels measured according to ISO 60704.

** Average data. Crated weight/shipping volume depends on configuration. Please contact logistics for exact measures.

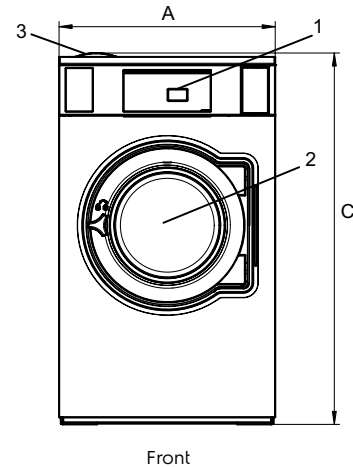

Front

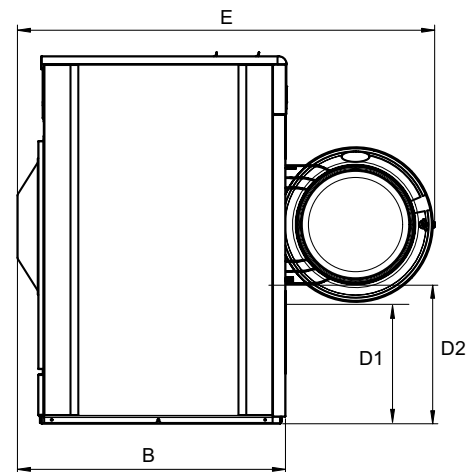

Side view

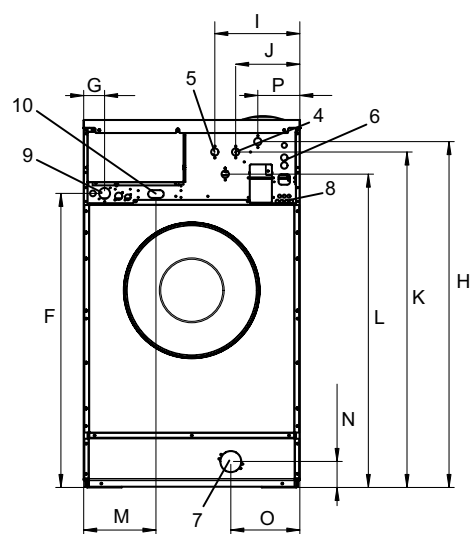

Rear